

## Medite FR Provides 30 Minute Partition Wall

Medite Europe Ltd is the first in the MDF Industry to successfully test and have certified by Warrington Fire Research Station Ltd, a non-load bearing partition design utilising MDF as its skin material. A partition design was submitted for testing in accordance with BS476:Part 22:1987, Clause 5. The specimen easily satisfied the performance requirements of minimum 30 minutes for integrity and 30 minutes for insulation and was confirmed by Warrington Test report Warres No 62385.

The design requirement was for a symmetrical non-load bearing partition which utilised two skins of Medite FR Class 1 to BS476:Part 7:1987. Insulation was achieved using Rockwool RW5 Mineral Wool Slabs and studs were galvanised mild steel 'c' profile with perimeter channel of galvanised mild steel. For specification of components please refer to "Schedule of Components" overleaf.

The Standard further permits modifications to be made to the original construction design, providing an assessment by the Fire Test Centre in accordance with the Fire Test Study Group Resolution No 64a 1993. An assessment was subsequently made (Report WFRC C81527) and it deemed that the modifications detailed below have been successfully validated and that they should be capable of satisfying the integrity and insulation criteria of the testing standard for the required period of 30 minutes.

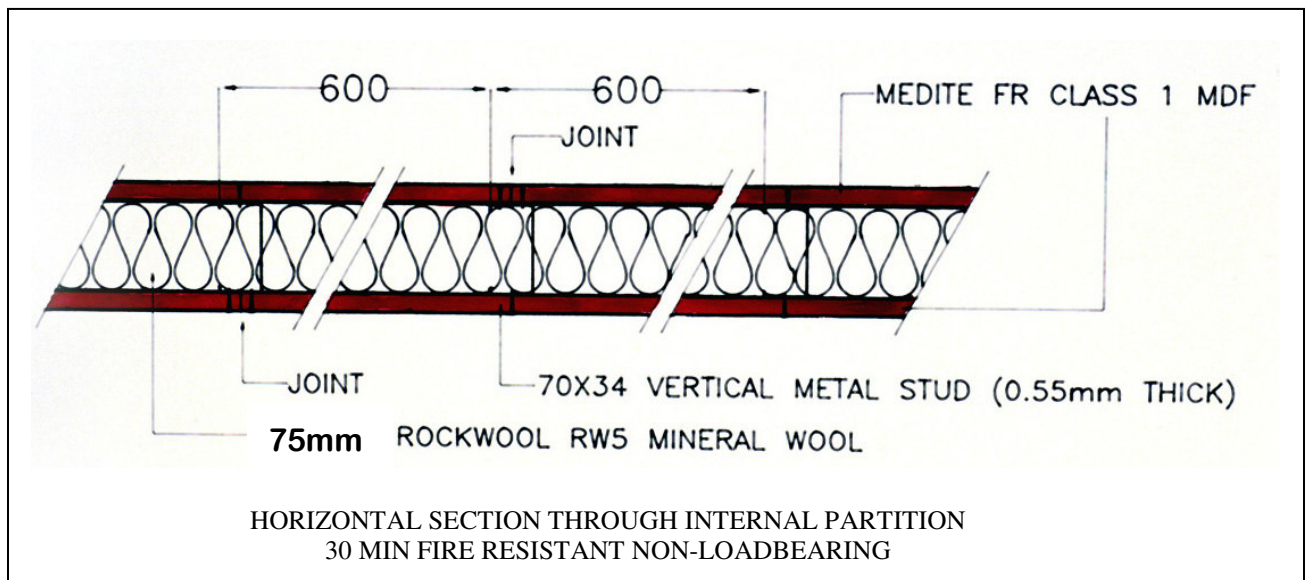

**Notes:** 15mm and 18mm Medite FR Class 1 fixed to metal or softwood studs incorporating Rockwool Mineral Wool RW5. Please note that 15mm is only acceptable providing the horizontal joints of the Mineral Wool are fixed at a minimum of 100mm from the horizontal joints of the Medite FR MDF (see modification).

Medite FR Class 0 may be substituted for Medite FR Class 1 facings without reducing the fire integrity of the partition.

These specifications must be strictly adhered to in order to conform to the necessary regulations.

## Schedule of Components

Item	Description
1.	Perimeter channel of galvanised mild steel, 71mm by 30mm by 0.55mm thick (including galvanizing), channels fixed to head, base and one vertical edge only using steel shot-fixings at 600mm centres.
2.	Studs of galvanised mild steel referenced 'Diamond 70 S 55', 70mm by 34mm by 0.55mm thick (including galvanizing). Studs provided with rectangular slots in the webs, of size 100mm by 40mm at 600mm centres. Studs friction fitted into the top and bottom channels with a 20mm gap for expansion at the head.
3.	Mineral wool insulation slabs referenced 'Rockwool RW5' , 900mm by 600mm by 75mm by 92kg/m <sup>3</sup> . Insulation friction fitted into the studs and channels with the horizontal and vertical joints butted together.
4.	Lining boards referenced Medite FR Class 1, 18mm thick by 2440mm high by 1220mm wide by 739kg/m <sup>3</sup> measured density. The vertical butt joints were staggered with respect to those on the opposite face.
5.	Fixing for lining boards with steel countersunk screws 38mm long by 3mm diameter at 300mm centres.

### Modifications

- (i) 15mm Medite FR Class 1 skins are acceptable provided that the horizontal joints in the mineral wool be at least 100mm away from the horizontal joints of the Medite FR Class 1 lining material.
- (ii) Partitions incorporating steel stud partitions, as compared with timber stud partitions are expected to achieve a lower fire resistance by actual fire test experience. The assessment states that substitution of the steel studding by softwood studding satisfied the criteria for 30 minutes integrity.

### Technical advice and stockist information

For stockist information, please contact:

Coillte Panel Products  
Persimmon House  
Anchor Boulevard  
Crossways Business Park  
Dartford  
Kent DA2 6QH  
Phone 01322 424900  
Fax 01322 424920  
Medite-europe.com

For technical information, please contact:

Medite Europe Ltd  
Redmondstown  
Clonmel  
Co Tipperary  
Ireland  
Fax Technical Information Line: +353 (0) 52 82300